

## SOLID INSERT GUIDES

These guides give the greatest possible support to the blade and are therefore the most suitable for precision sawing utilising standard location points. Solid insert guides as the name implies, have the guiding faces machined into a solid block, thereby eliminating the need for individual adjustment. The guide inserts (item 21) are made in a range of sizes to suit blades widths and thicknesses.

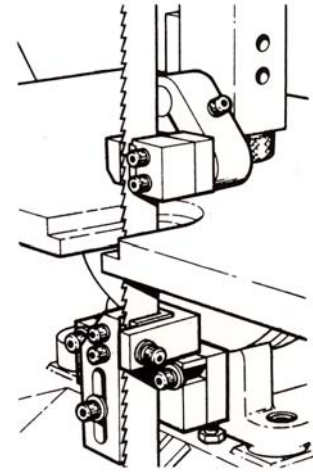

Upper Assembly No. SM624

| ITEM | PART NO | DESCRIPTION    | QTY |
|------|---------|----------------|-----|
| 1    | BO5010  | SCREWS         | 2   |
| 2    | 4157    | INSERT LOCATOR | 1   |
| 3    | 4158    | STEM           | 1   |
| 4    | 4156    | GUIDE ARM      | 1   |
| 5    | 4154    | SPIGOT         | 1   |
| 6    | BO5028  | SCREW          | 1   |
| 7    | BO5870  | SCREW          | 1   |

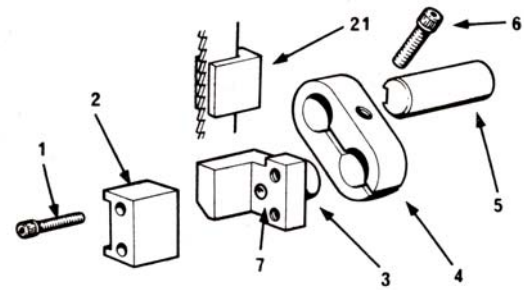

Upper Assembly No. SM712

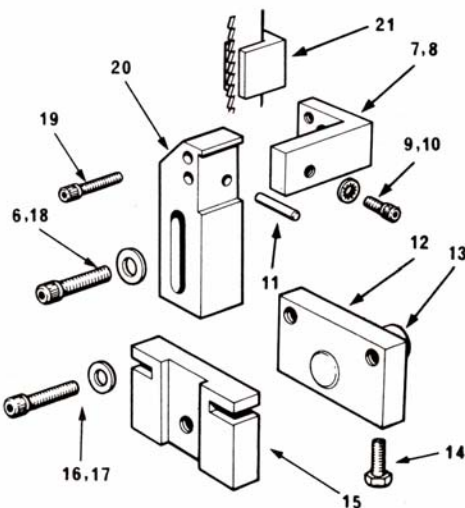

| ITEM | PART NO | DESCRIPTION       | QTY     |      |
|------|---------|-------------------|---------|------|
| 6    | BO5028  | SCREW             | 1       |      |
| 7    | BO5870  | SCREW             | 1       |      |
| 8    | 4326    | INSERT LOCATOR    | 1       |      |
| 9    | BO5942  | SHAKEPROOF WASHER | 1       |      |
| 10   | BO5004  | SCREW             | 1       |      |
| 11   | BO5331  | MILLS PIN         | 1       |      |
| 12   | 4324    | BACK PLATE        | 1       |      |
| 13   | 4327    | SPIGOT            | 1       |      |
| 14   | BO5501  | SCREWS            | 2       |      |
| 15   | 4325    | STEM HOLDER       | 1       |      |
| 16   | BO5915  | WASHERS           | 2       |      |
| 17   | BO5021  | SCREWS            | 2       |      |
| 18   | BO5918  | WASHER            | 1       |      |
| 19   | BO5011  | SCREWS            | 2       |      |
| 20   | 4323    | STEM HOLDER       | 1       |      |
| 21   | BLADE   | BLADE THICKNESS   | OLD NO. |      |
|      |         | 0.025             | 0.035   |      |
|      | 1/8"    | SM2863            | SM2873  | 4146 |
|      | 3/16"   | SM2864            | SM2874  | 4147 |
|      | 1/4"    | SM2865            | SM2875  | 4148 |
|      | 3/8"    | SM2866            | SM2876  | 4149 |
|      | 1/2"    | SM2867            | SM2877  | 4150 |
|      | 5/8"    | SM2868            | SM2878  | 4151 |
|      | 3/4"    | 4152/A            | 4152/B  |      |

## MACHINE SPARES LTD.

Garratt St. Brierley Hill, West Midlands, DY5 1JU.

Tel: 0870 870 2550 fax: 0870 870 2660